

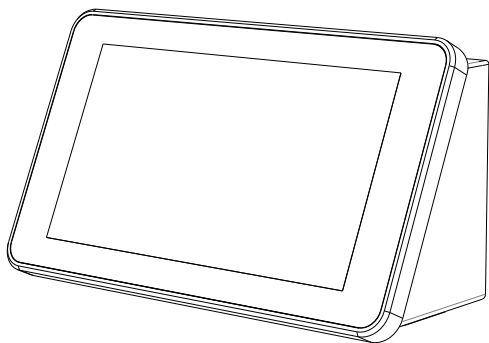

**MULTICORE**  
RESEARCH & DEVELOPMENT

ROBUST CONSTRUCTION  
USB CONNECTION OUTPUT  
STANDARDIZED WALL MOUNT  
FLIP POSSIBILITY DISPLAY MOUNTING  
CUSTOMIZING POSSIBILITY



## Horizontal Wall mount for original Raspberry Pi 7" display

INSTRUCTION MANUAL - 20201101ENG



### DIMENSIONS

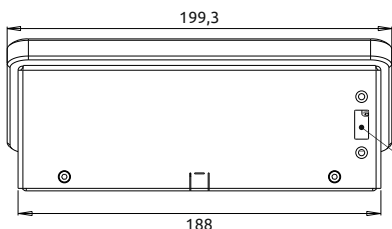
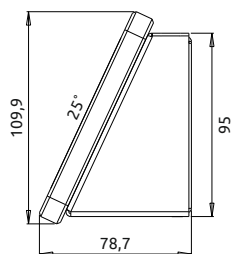
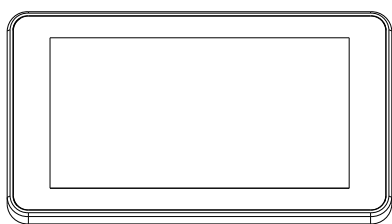
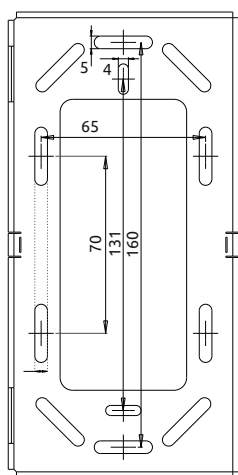

Weight : 680g  
IP : IP20  
Panel material : POM-C  
Frame material : DC01  
Screw torque : 0,5Nm<sup>-1</sup>

for USB accessories

### PACKAGING

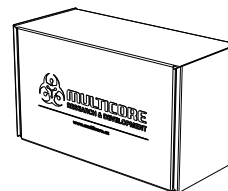

Dimensions : 218x123x95mm  
Weight : 695g

Included:  
- 1x Display plate  
- 1x Console  
- 2x Screw M3x5 DIN 7991  
- 5x Screw M3x5 DIN 912  
- 7x Screw M3x5 DIN 912  
- 4x Set of dowels & screw  
- 1x Hex key 2mm  
- 1x Hex key 2,5mm with ball  
- 1x mcPROTECTOR (BASIC)

### CABLE INPUTS POSSIBILITIES

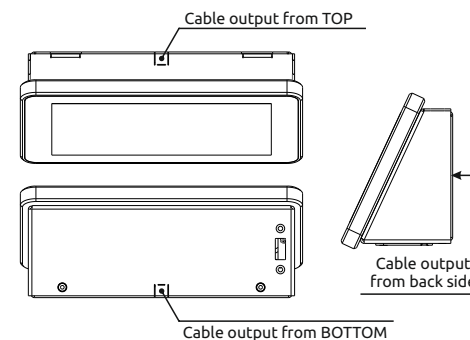

### ACCESSORIES (not included)

mcHAT with POE, RTC  
and cooling system

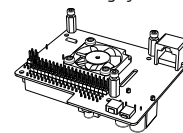

Raspberry Pi 2,3,3B,3B+,4 compatible

USB 2.0 Connector  
extension with safety cover

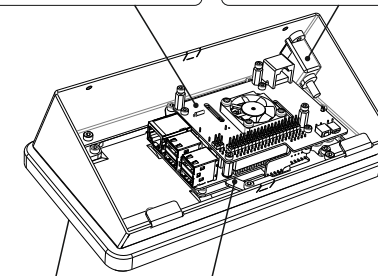
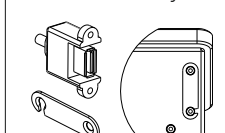

Low profile mounting set

mcHAT compatible and recommended

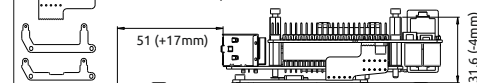

mcPROTECTOR (BASIC, PREMIUM, ANTIBACTERIAL ...)

### SWING OUT BY PLIERS FOR USE CABLE OUTPUT

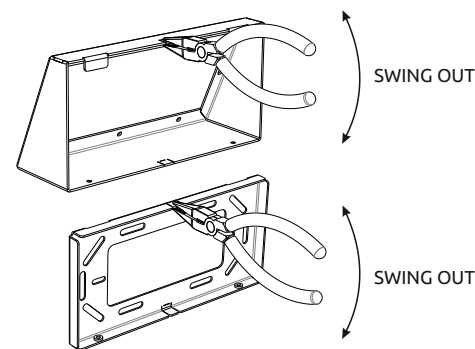

SAVING RECOMMENDED AFTER SWING OUT

### MOUNTING AT DOWELS

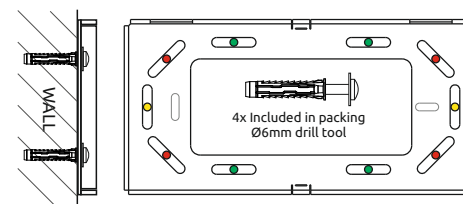

### DISPLAY MOUNTING POSSIBILITIES

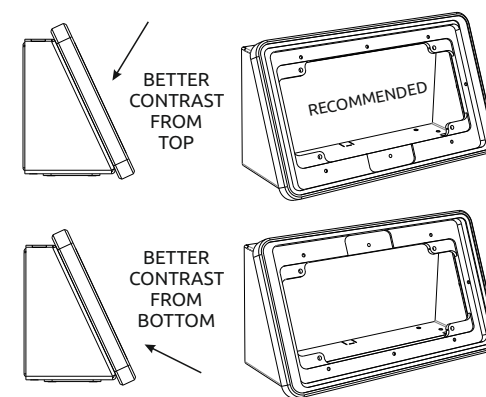

### MOUNTING AT 2 POSITION INSTRUMENT BOX

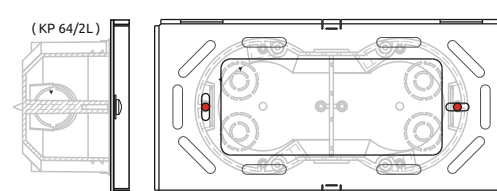

1.

 M3x5 (2x)

 M3x5 (5x)

 M3x6 (7x)

 (4x)

2mm (1x)

2,5mm (1x)

mcPROTECTOR  
screen protection

(1x)

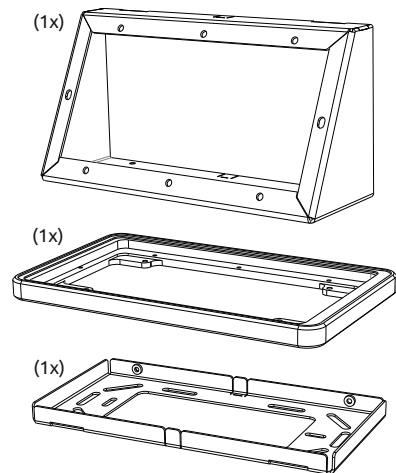

2.

From packing is this step done.

1x M3x5  
7x M3x6

Rotate 180deg for better contrast from bottom side  
Default mounting is for better contrast from top side  
see "DISPLAY MOUNTING POSSIBILITIES"

M3x5 in position for display cable

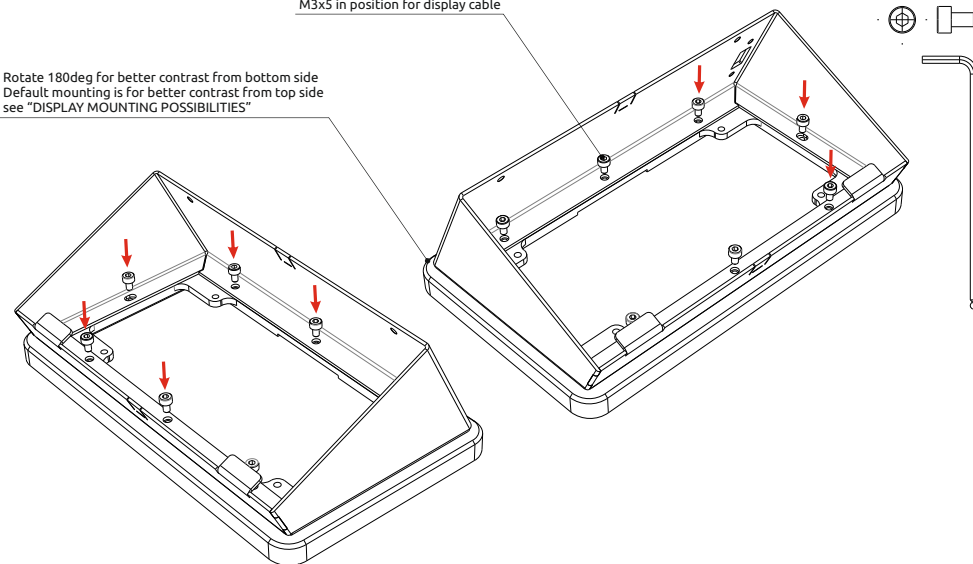

3.

4x M3x5

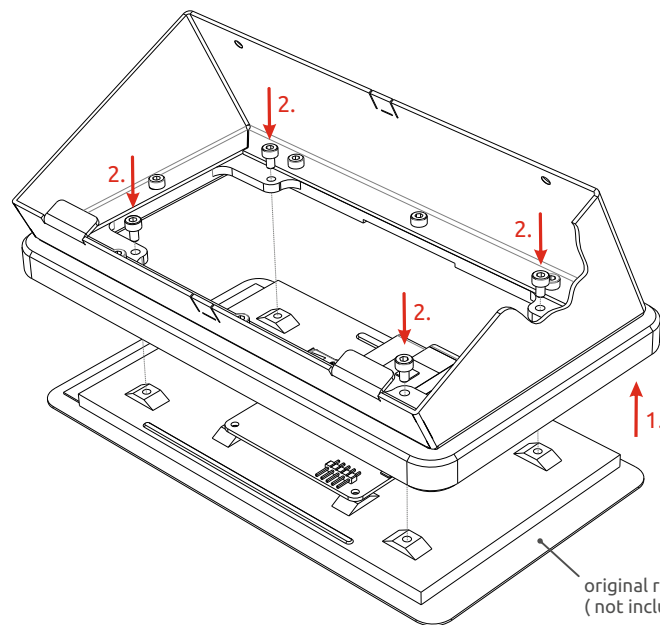
original raspberry pi 7" display  
(not included)

4.

2x M3x5

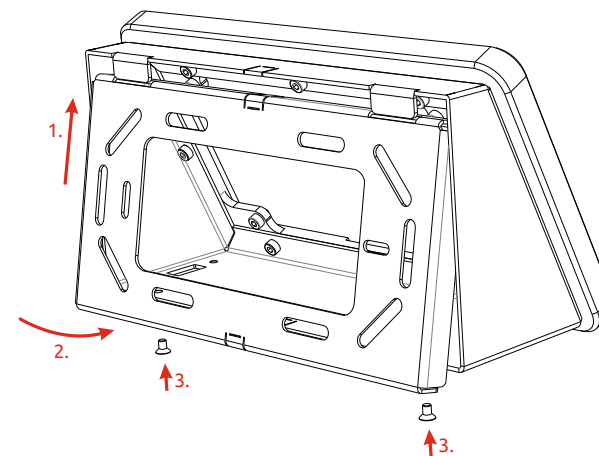

5.

1x mcPROTECTOR

**Install screen protector by mounting kit in these steps :**

1. Remove original display protection foil
2. Locate a dust free area and carefully remove any dust or dirt from the display by using of wet pad and cleaning wipe (included in mcPROTECTOR packaging)
3. Remove half of the thin cover film of the screen protector on one side with your screen. Make sure that the screen protector will be centered on the middle of screen.
4. Carefully slide over the screen protector from one side to the other on your screen by soft cloth, enabling you to remove the rest of the thin cover film.
5. Smooth any remaining air bubbles. You can also use any credit card covered with soft cloth over the edge.